

Online Registration Process Anaheim Family YMCA

Click on the **Log-in** button on the right corner.

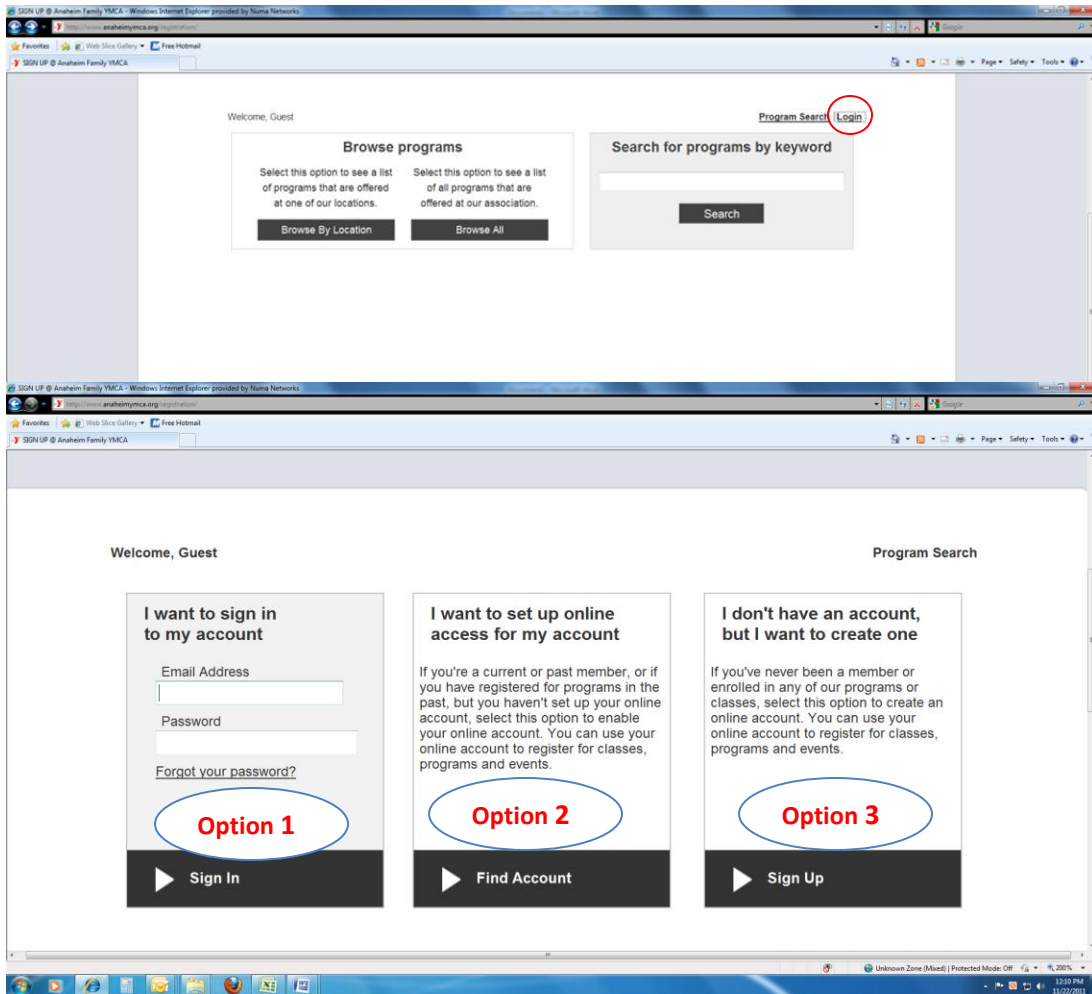

3 options:

1. **Sign In:** This is if you have registered online before and know your email & password.
Note: If you know you have an account but forgot your password, click on forget password and directions will be emailed to you. If you forgot which email you used, please email bclendening@anaheimymca.org or call Beth Clendening 714-635-9622 ext.1603.
2. **Find Account:** This is for participants that have been enrolled in an Anaheim Family YMCA (including Anaheim Achieves) program within the last 5 years but have never registered online.
 - You will need to enter the primary parent's last name, birth date, & zip code.
Note: If you cannot locate your unit please do not create a new account please email bclendening@anaheimymca.org or call Beth Clendening 714-635-9622 ext.1603.
3. **Sign-up:** This is for all **first time** participants to the Anaheim Family YMCA. You will need to create a new account. Please follow the instructions below for creating a new account.

Create New Account (Option 3)

1. Click on Sign-up
2. Enter Primary Member

The Member Name you would put in first will be the primary member. The Primary Member should be the Adult who is the head of the household. Parents/Guardians should be entered before child participants.

Welcome, Guest Program Search | Login

Create a New Account
Please enter your personal and contact information.

* indicates a required field

Your Information

Member Info

Member Name*	First Name	Middle Name	Last Name
	<input type="text"/>	<input type="text"/>	<input type="text"/>

Gender: -- Select Below --

Birthdate:

3. Select Account Types:
 - Select Branch- **Anaheim Family YMCA**

Welcome, Guest Program Search | Login

Select Account Type

Please select a location from the dropdown list below where you would most frequently visit or attend programs. For questions please visit our website for further details about our locations.

Select Branch:

No Online Membership Types Available

Cancel

- Select Account Type- **Participant**

Welcome, Guest Program Search | Login

Select Account Type

Please select a location from the dropdown list below where you would most frequently visit or attend programs. For questions please visit our website for further details about our locations.

Select Branch: Anaheim Family YMCA

Account Type	Account Fee	Select
Non-member	None	<input type="radio"/>
Participant	None	<input type="radio"/>

Cancel

4. Enter All Members of the Family

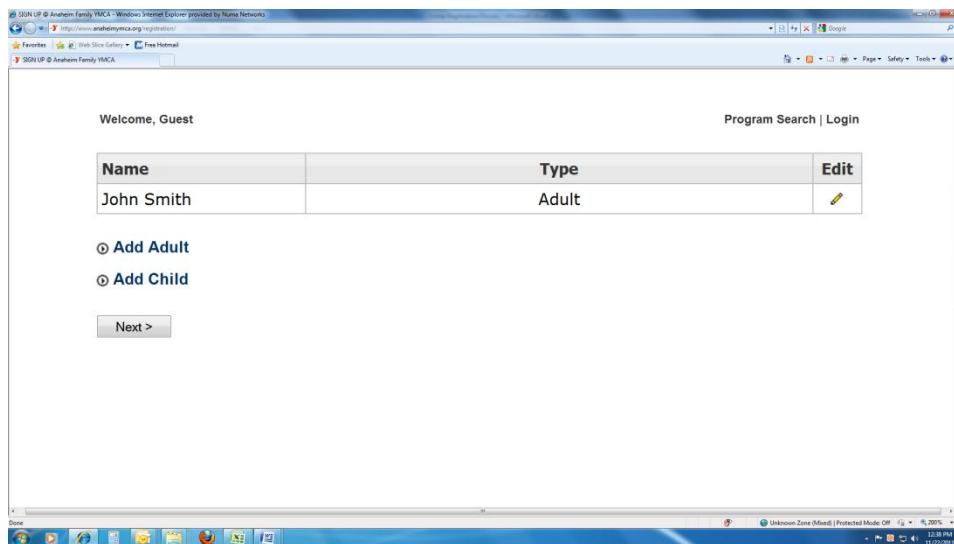

5. Create Account Password

Email Address- will be your login, this is where confirmation & payment receipts will be sent.

Password- Must contain at least 4 characters.

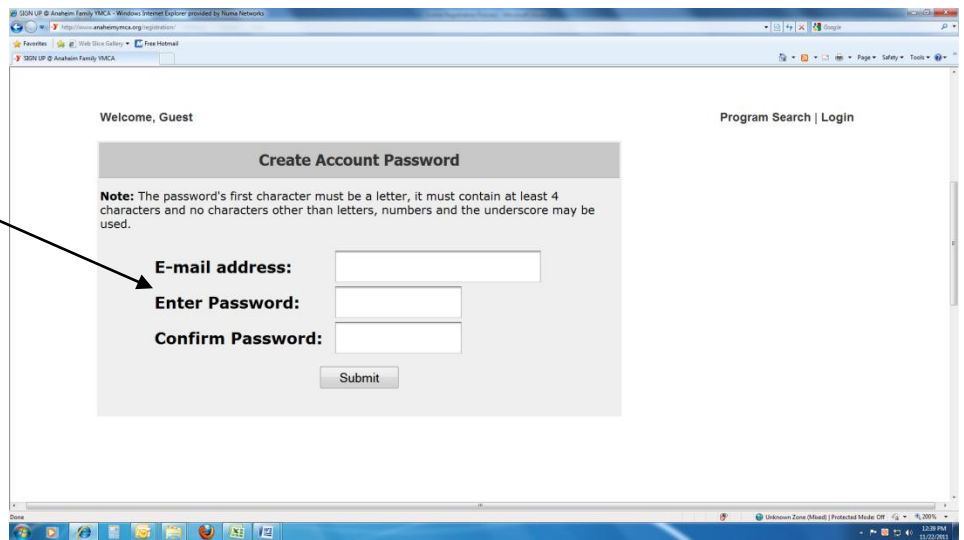

If you have any questions or have any trouble with online registration please contact:

Beth Clendening
bclendening@anaheimymca.org
714-635-9622